

- ☒ The product is intended for general indoor use according to the applicable standard of protection - Ip20, i.e. for installation inside buildings and in areas not directly exposed to moisture or water!
- ☒ The lighting complies with all necessary CE, RoHS certificates for everyday use
- ☒ The light source is LED strips fitted with SMD components
- ☒ The product is guaranteed for 24 months from the date of sale.
- ☒ The warranty does not cover damage resulting from improper handling, accidents, wear and tear, use of the item contrary to the purpose given by the manufacturer, failure to follow the operating instructions.
- ☒ The warranty also does not cover damage caused by atmospheric influences, overvoltage, mechanical or electrical damage to input and output parts and power supply assemblies.
- ☒ The surface of the luminaire can be cleaned with a dry or damp cloth using common cleaning agents designed for these purposes.
- ☒ The light is dimmable.
- ☒ In the event of a malfunction, please contact only authorised persons with valid qualifications in accordance with decree No. 50/1978Sb. or contact us at info@li-go.eu.

● LED Light-image - battery powered

Intended placement:	Wall mounted
Material used:	Wooden fibreboard
Dimming:	Yes, with a push-button
Colour of decorative light:	Shades of white light, additional colours depending on chosen design
Light source:	LED strip - 1m @ 12V/4,8W/0,4
Supply output voltage:	5V DC/2A
Supply power output:	10W
LED source lifetime	100 000 hodin

● Yenkeee 30 000 mAh battery

Capacity	- 30 000 mAh
Charging cable	- Not included
Charger for USB charging	- not included, mobile phone charger can be used, minimum 2A, The luminaire can be recharged by all common chargers, 2A output, connectors "microUSB and iPhone" .
Weight	- 640g
Battery type	- Li - Polymer
Dimensions	- 165 x 82 x 32 mm



The battery or accumulator that may be included in the product is subject to a warranty of six months, as they are consumables.



● Mounting the luminaire

Always remove the battery after unpacking the luminaire. The battery can only be inserted into the luminaire if it is upright on the wall. The battery is not firmly attached to the luminaire and would fall out during handling.



- Two staples with dowels are included for wall mounting.
- Measure a 320mm pitch on the wall and drill 5mm diameter holes in the wall
- Insert dowels, screw in staples.
- Hang the luminaire.

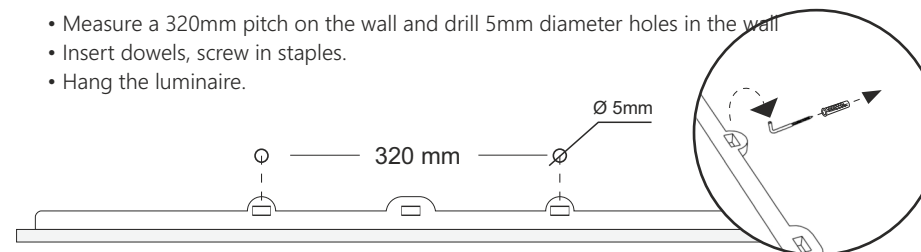

● Pairing the DIM-LED remote control

If you have purchased a remote control for the luminaire and it is not paired with the luminaire, proceed as follows: Remove the foil from the remote control to protect the battery against discharge. Switch the luminaire off (with the battery button), then switch the luminaire on again (with the battery button), within 5 seconds, briefly press the on/off button on the remote control 3 times. The connected light flashes 3 times and is paired.



If the controller does not work properly, replace the battery in the controller with a new one.

1. **Always remove the battery** after unpacking the luminaire. The battery can only be inserted into the luminaire if it is upright on the wall. The battery is not firmly attached to the luminaire and would fall out during handling.
2. Hang the luminaire on both clips so that it hangs stably on the wall, see first page of the manual.
3. Insert the charged battery into the luminaire (**Figure A**).
Note: when inserting the battery, the button (on the side) must be facing out of the luminaire!
4. Insert the USB connector into the battery (**Figure B**).
5. Switch on the luminaire by pressing the button located on the bottom of the battery (**Figure C**).
If you hold the button for 3 seconds, the luminaire will turn off.
6. The brightness of the luminaire can be adjusted using the button located on the side of the luminaire (**Figure D**).
Note: If the brightness is reduced to a greater extent, the battery will switch off, so it is not a fault.
7. The battery charge status can be seen on the battery display.

CHARGING THE BATTER

You can charge the battery without removing it (**Figure F**) or anywhere after removing it, but first you must disconnect the battery first. To do this, remove the USB connector from the battery (**Figure G**),

Then slide the battery out of the bottom of the panel with your fingers (**Figure H**).

The battery is charged with a standard charger, e.g. for mobile phones. The minimum charging current is 2A (charger not included). The lamp can be recharged with all common chargers with "microUSB" connectors, USB-C, iPhone". If the battery is charging too slowly, the cause is a weak power supply or charging cable.

WE RECOMMEND

If you use the luminaire more often, it is ideal to purchase a second battery, which can always be charged and ready to go. Then you just change the batteries and the luminaire can shine continuously. The battery is universal powerbank and can be used at home or when travelling.

REMOTE CONTROL

The function of switching on with the remote control is limited, you must first manually activate it with the button on the battery. The picture can only be switched off or brightness can be added and subtracted.

The battery enters a power-saving mode when the luminaire is switched off.

The battery button must be pressed to switch on the battery back on again.

Caution: the luminaire may switch off spontaneously if the brightness is set too low. This is not a malfunction, it is a function of the battery to protect it against discharge.

